

## Knurled Nuts

Steel / Stainless Steel, Flat Type

### SPECIFICATION

#### Version in Steel

- Property class 5
- Visible face fine turned
- Blackened
- Zinc plated, blue passivated **ZB**

#### Version in Stainless Steel

- Stainless Steel AISI 303 **NI**
- Matte shot-blasted

### INFORMATION

Knurled nuts DIN 467 are suitable for universal use and can be tightened and loosened easily without tools. A nut with thread M12 is also available in addition to the types defined in the DIN standard.

### ON REQUEST

- Version in stainless steel (A4 quality)

### TECHNICAL INFORMATION

- Stainless Steel Characteristics (see page A26)
- Strength Values of Screws (see page A20)

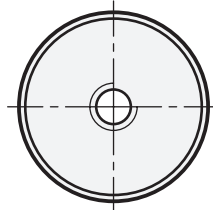
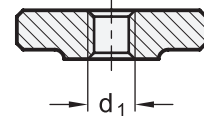
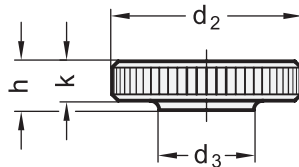

### DIN 467

Description	d1	d2	d3	h	k	⚖️
DIN 467-M3	M 3	12	6	3	2.5	2
DIN 467-M4	M 4	16	8	4	3.5	5
DIN 467-M5	M 5	20	10	5	4	9
DIN 467-M6	M 6	24	12	6	5	17
DIN 467-M8	M 8	30	16	8	6	32
DIN 467-M10	M 10	36	20	10	8	62
DIN 467-M12	M 12	40	22	12	10	92

### DIN 467-ZB

Description	d1	d2	d3	h	k	⚖️
DIN 467-M3-ZB	M 3	12	6	3	2.5	2
DIN 467-M4-ZB	M 4	16	8	4	3.5	5
DIN 467-M5-ZB	M 5	20	10	5	4	9
DIN 467-M6-ZB	M 6	24	12	6	5	17
DIN 467-M8-ZB	M 8	30	16	8	6	32
DIN 467-M10-ZB	M 10	36	20	10	8	62
DIN 467-M12-ZB	M 12	40	22	12	10	92

### DIN 467-NI

### STAINLESS STEEL

Description	d1	d2	d3	h	k	⚖️
DIN 467-M3-NI	M 3	12	6	3	2.5	2
DIN 467-M4-NI	M 4	16	8	4	3.5	5
DIN 467-M5-NI	M 5	20	10	5	4	9
DIN 467-M6-NI	M 6	24	12	6	5	17
DIN 467-M8-NI	M 8	30	16	8	6	32
DIN 467-M10-NI	M 10	36	20	10	8	62
DIN 467-M12-NI	M 12	40	22	12	10	92